

KNOCKOUT IN CONE AND FINISH PUNCH*

For 3/16" Machines under Serial Number 31537
For 1/4" Machines under Serial Number 32377
For 5/16" Machines under Serial Number 32820

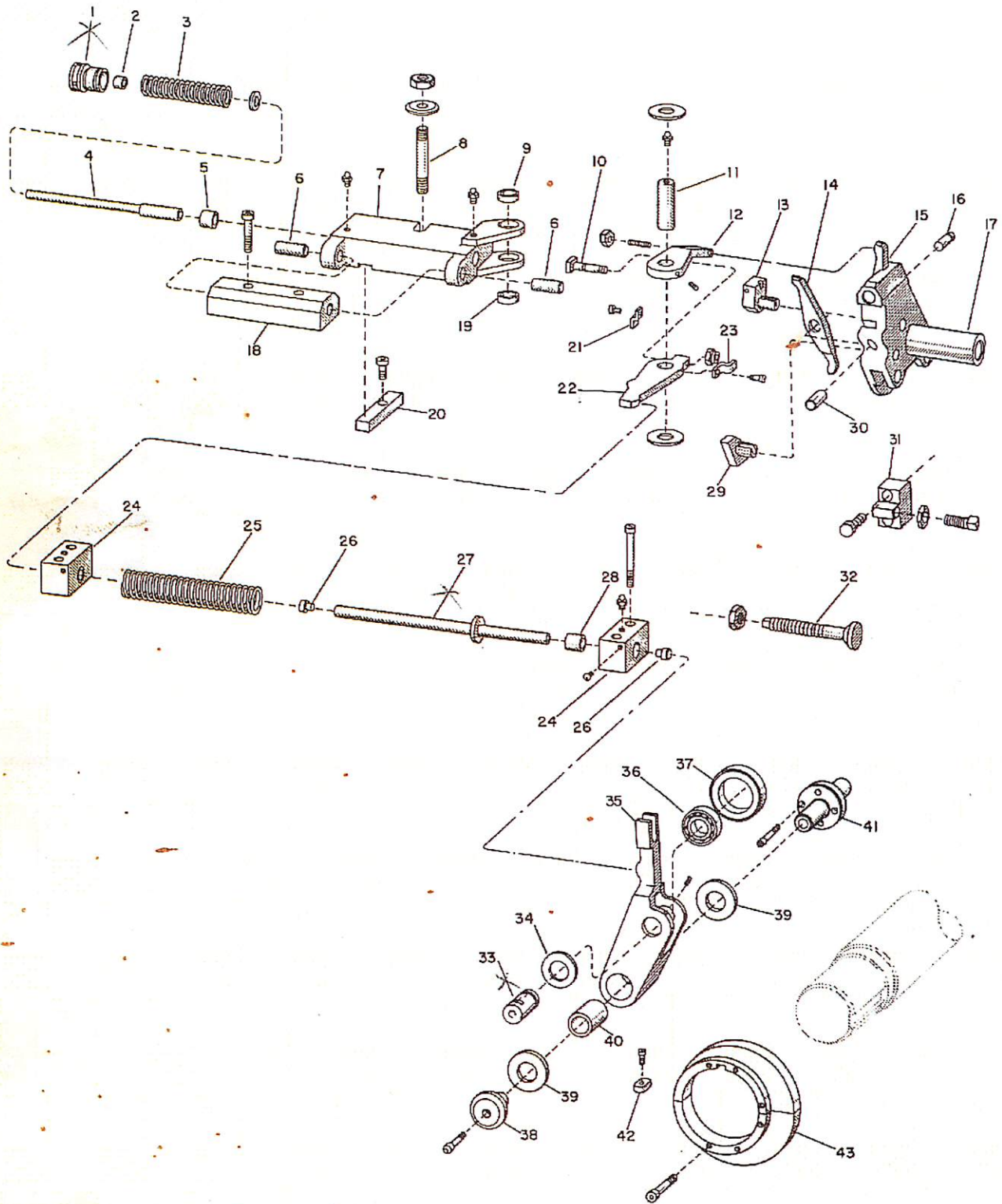

Figure 20

KNOCKOUT IN CONE AND FINISH PUNCH*

KEY NO.	PART NAME	QTY.
20-1	Front Spring Adjusting Screw	1
20-2	Bush in Front Spring Adjusting Screw	1
20-3	Front Spring	1
20-4	Front Knockout Lever Spring Rod	1
20-5	Bush in Front of Knockout Lever Bracket	1
20-6	Dowel in Front Knockout Lever Bracket	2
20-7	Front Knockout Lever Bracket	1
20-8	Stud on Front Knockout Lever Bracket	1
20-9	Bush in Front Knockout Lever	1
20-10	Breaker Bolt in Front Knockout Lever	1
20-11	Front Knockout Lever Fulcrum Pin	1
20-12	Breaker Bolt Lever	1
20-13**	Finish Punch Holder Centering Block	1
20-14**	Kickout Lever in Punch Rocker for Cone Punch	1
20-15	Knockout Lever in Punch Rocker for Finish Punch	1
20-16	Pin for Knickout Lever in Punch Rocker	1
20-17	Punch Rocker	1
20-18	Hinge Block for Bracket	1
20-19	Bush in Front Knockout Lever	1
20-20	Key for Bracket	1
20-21	Breaker Bolt Retainer	1
20-22	Front Knockout Lever	1
20-23	Knockout Lever Breaker Bolt Retainer	1
20-24	Push Rods Supports	2
20-25	Spring	1
20-26	Ends for Knockout Push Rod	2
20-27	Knockout Push Rod	1
20-28	Bush in Push Rod Supports	2
20-29**	Cone Punch Holder Centering Block	1
20-30**	Pin for Kickout Lever in Punch Rocker	1
20-31#	Latchout Block	1
20-32+	Latchout Screw for Kickout Roller Lever	1
20-33	Rear Knockout Lever Roller Pin	1
20-34	Rear Knockout Lever Roller Pin Washer	2
20-35	Rear Knockout Roller Lever	1
20-36	Rear Knockout Lever Roller Bearing	1
20-37	Rear Knockout	1
20-38	Rear Knockout Lever Check Retainer	1
20-39	Washer Rear Knockout Lever Fulcrum Pin	2
20-40	Bush for Rear Knockout Lever	1
20-41	Rear Knockout Lever Fulcrum Pin	1
20-42	Bracket in Cam on Eccentric Shaft	1
20-43##	Cam on Eccentric Shaft	1

+On 3/16" and 5/16" Machines Only

##Specify for long or short kick.

#On 1/4" Machine Only

**On machines with kickout in the cone and finish punches only.

*For 3/16" Machines under Serial Number 31537

For 1/4" Machines under Serial Number 32377

For 5/16" Machines under Serial Number 32820