

RELIEVING KNOCKOUT MECHANISM

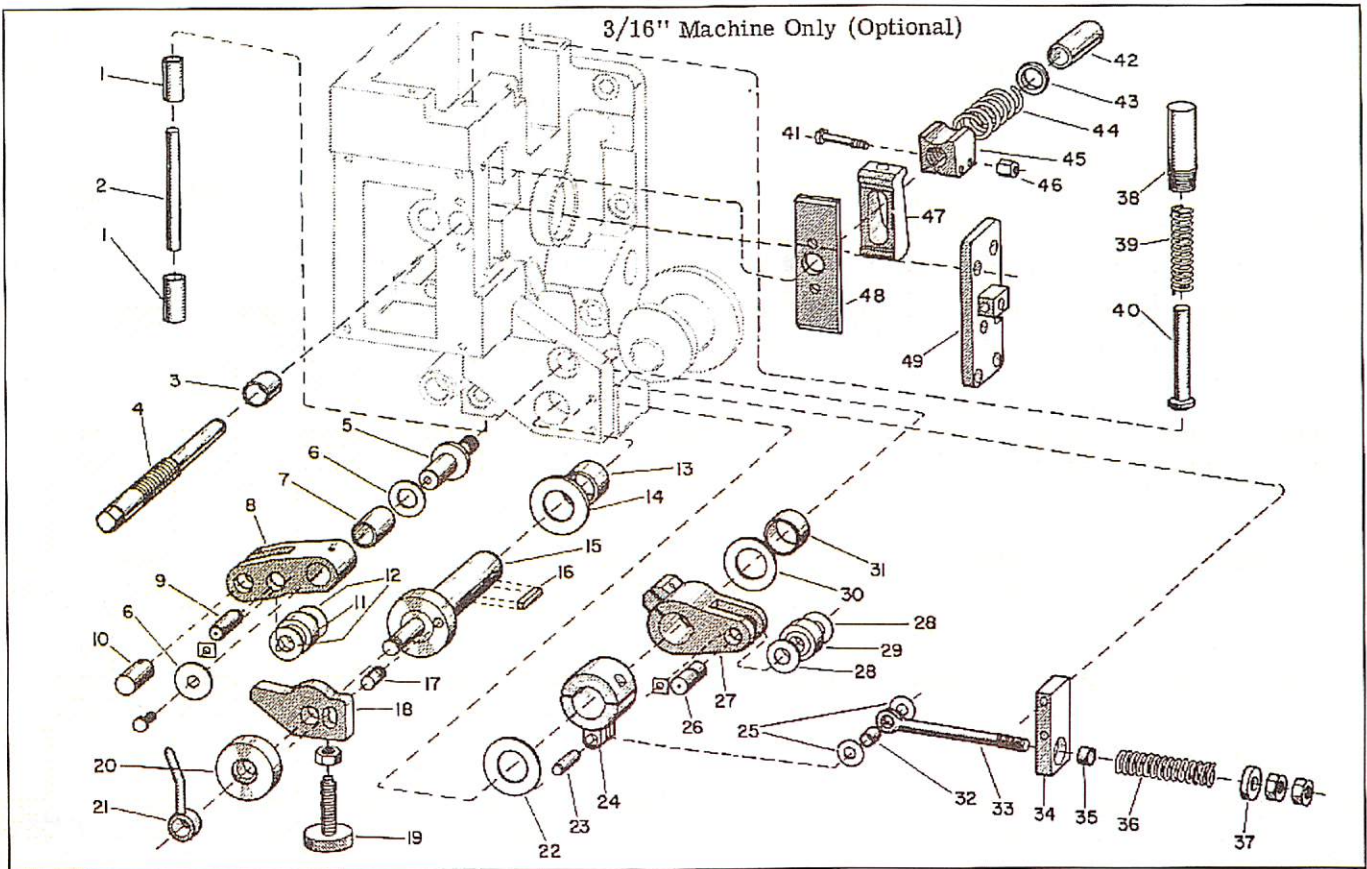

Figure 23

RELIEVING KNOCKOUT MECHANISM (Optional)

KEY NO.	PART NAME	QTY	KEY NO.	PART NAME	QTY
23-1	Bushings on Wedge Lift Rod . . . . .	2	23-24	Roller Lever Shaft Collar . . . . .	1
23-2	Wedge Lift Rod . . . . .	1	23-25	Washers on Spring Rod . . . . .	2
23-3	Kickout Backing Screw Bushing. . . . .	1	23-26	Roller Lever Pin . . . . .	1
23-4	Kickout Backing Screw . . . . .	1	23-27	Relieving Knockout Roller Lever. . . . .	1
23-5	Intermediate Lever Pivot Pin . . . . .	1	23-28	Washers on Needle Bearing . . . . .	2
23-6	Washers on Intermediate Lever . . . . .	2	23-29	Needle Bearing on Roller Lever . . . . .	1
23-7	Intermediate Lever Bushing . . . . .	1	23-30	Washer on Roller Lever Shaft. . . . .	1
23-8	Intermediate Lever. . . . .	1	23-31	Bushing on Roller Lever Shaft . . . . .	1
23-9	Intermediate Lever Roller Pin . . . . .	1	23-32	Bushing on Spring Rod. . . . .	1
23-10	Intermediate Lever Pin . . . . .	1	23-33	Spring Rod for Relieving Knockout Cam. . . . .	1
23-11	Needle Bearing on Intermediate Lever Roller Pin . . . . .	1	23-34	Spring Bracket. . . . .	1
23-12	Washers on Needle Bearing . . . . .	2	23-35	Bushing in Bracket . . . . .	1
23-13	Front Bushing - Roller Lever Shaft. . . . .	1	23-36	Spring on Spring Rod. . . . .	1
23-14	Washer on Roller Lever Shaft. . . . .	1	23-37	Spring Seat . . . . .	1
23-15	Relieving Knockout Roller Lever Shaft. . . . .	1	23-38	Wedge Return Spring Tube. . . . .	1
23-16	Key on Roller Lever Shaft . . . . .	1	23-39	Wedge Return Spring. . . . .	1
23-17	Guide Pin for Adjusting Cam . . . . .	1	23-40	Wedge Return Spring Rod. . . . .	1
23-18	Relieving Knockout Adjusting Cam. . . . .	1	23-41	Clamping Bolt . . . . .	2
23-19	Adjusting Knob on Relieving Knockout Cam . . . . .	1	23-42	Bushing on Kickout Backing Screw. . . . .	1
23-20	Clamp for Relieving Knockout Cam Adjustment . . . . .	1	23-43	Spring Seat for Spring on Kickout Backing Screw . . . . .	1
23-21	Lock Handle - Relieving Knockout Cam Adjustment . . . . .	1	23-44	Spring on Kickout Backing Screw. . . . .	1
23-22	Washer on Roller Lever Shaft. . . . .	1	23-45	Backing Screw Nut . . . . .	1
23-23	Cam Spring Rod Pin . . . . .	1	23-46	Nut for Clamping Bolt. . . . .	2
			23-47	Relieving Knockout Wedge . . . . .	1
			23-48	Liner Behind Relieving Knockout Wedge	1
			23-49	Guide Tube Bracket . . . . .	1