

# KNOCKOUT IN CONE AND FINISH PUNCH

For 25 Machines with Serial Number 41000 and Higher  
For 3/16" Machines with Serial Number 31537 and Higher  
For 1/4" Machines with Serial Number 32377 and Higher

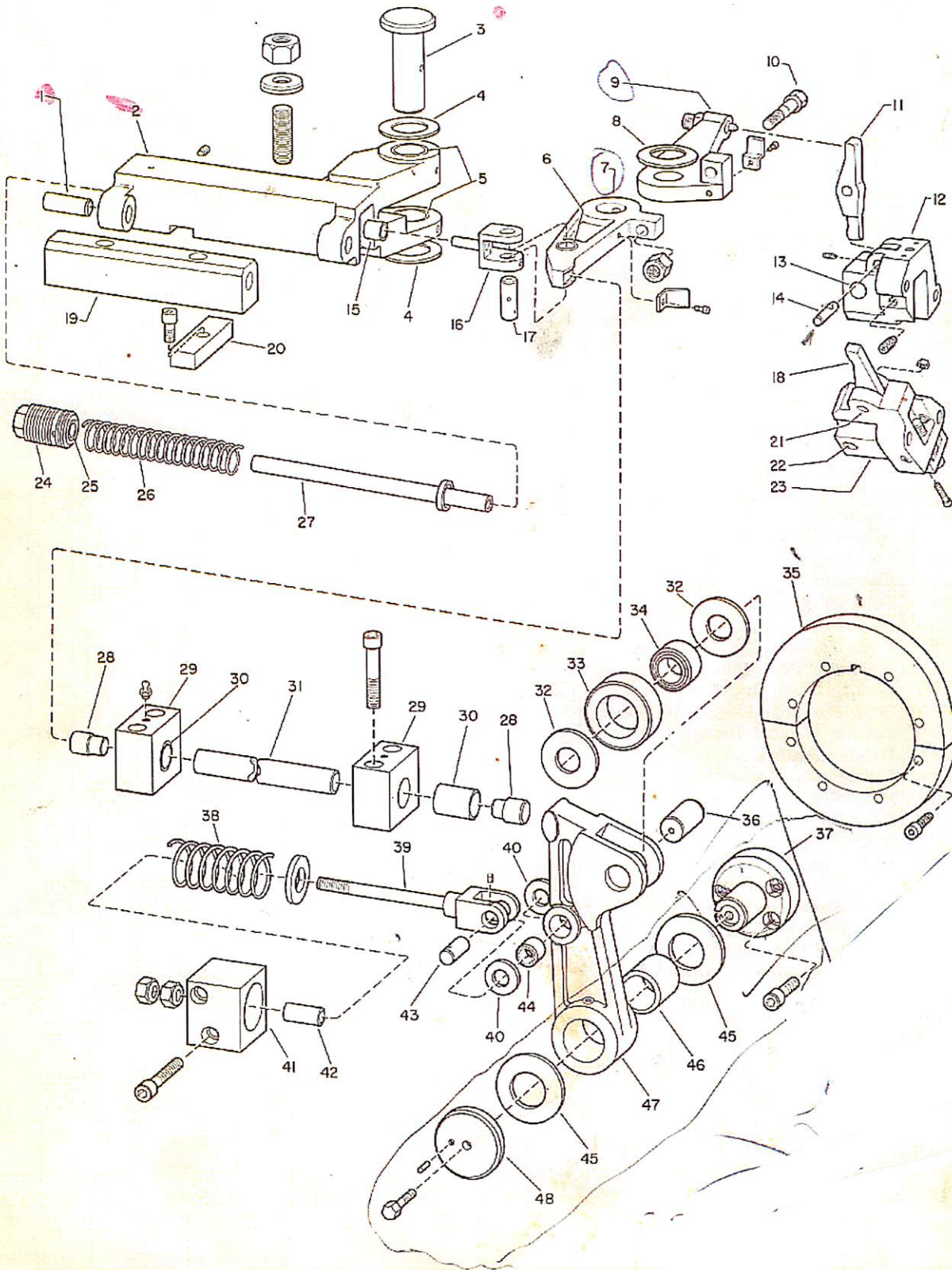

Figure 21



KNOCKOUT IN CONE AND FINISH PUNCH \*

KEY NO.	PART NAME	QTY.
21-1	Hinge Block Pivot Dowel . . . . .	2
21-2	Front Lever Bracket . . . . .	1
21-3	Front Lever Pivot Pin . . . . .	1
21-4	Lever Pivot Pin Washer . . . . .	2
21-5	Front Lever Bracket Bushing . . . . .	2
21-6	Breaker Bolt Lever Bearing . . . . .	1
21-7	Breaker Bolt Lever . . . . .	1
21-8	Lever Pivot Pin Washer . . . . .	1
21-9	Front Lever . . . . .	1
21-10	Front Lever Breaker Bolt . . . . .	1
21-11	K. O. Lever - Finish Punch . . . . .	1
21-12	Finish Punch Holder . . . . .	1
21-13	Clamp Bolt Assembly - Finish Punch . . . . .	1
21-14	Pivot Pin for Lever . . . . .	1
21-15	Spring Rod Bushing . . . . .	1
21-16	Spring Rod End . . . . .	1
21-17	Spring Rod End Pin . . . . .	1
21-18	K. O. Lever - Cone Punch . . . . .	1
21-19	Hinge Block for Bracket . . . . .	1
21-20	Key for Bracket . . . . .	1
21-21	Pivot Pin for Lever . . . . .	1
21-22	Clamp Bolt Assembly - Cone Punch . . . . .	1
21-23	Cone Punch Holder . . . . .	1
21-24	Spring Adjusting Screw . . . . .	1
21-25	Spring Adjusting Screw Bushing . . . . .	1
21-26	Front Spring . . . . .	1
21-27	Front Lever Spring Rod . . . . .	1
21-28	Push Rod End . . . . .	2
21-29	Push Rod Bracket . . . . .	2
21-30	Push Rod Bracket Bushing . . . . .	2
21-31	Push Rod . . . . .	1
21-32	Washers for Cam Roller . . . . .	2
21-33	Cam Roller . . . . .	1
21-34	Cam Roller Bearing . . . . .	1
21-35	Cam One Diameter Kick . . . . .	1
	Two Diameter Kick . . . . .	1
21-36	Roller Pin . . . . .	1
21-37	Roller Lever Pivot Pin . . . . .	1
21-38	Latchout Rod Spring . . . . .	1
21-39	Latchout Spring Rod . . . . .	1
21-40	Latchout Rod Pin Washer . . . . .	2
21-41	Latchout Rod Bracket . . . . .	1
21-42	Latchout Rod Bracket Bushing . . . . .	1
21-43	Latchout Rod Pin . . . . .	1
21-44	Latchout Rod Pin Bearing . . . . .	1
21-45	Washers for Roller Lever . . . . .	1
21-46	Roller Lever Bushing . . . . .	1
21-47	Roller Lever . . . . .	1
21-48	Roller Lever Check Retainer . . . . .	1

\* For 25 Headers with Serial Number 41000 and Higher  
 For 3/16" Headers with Serial Number 31537 and Higher  
 For 1/4" Headers with Serial Number 32377 and Higher